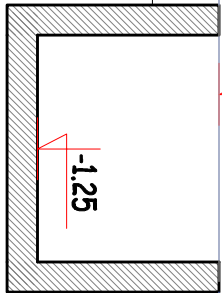

A diagram of a beam cross-section. The top flange is a black rectangle with a width of 15mm, indicated by a dimension line and the text "15MM". The web is a yellow I-beam shape. The top flange is positioned above the web, with a gap between them. The entire cross-section is enclosed within a dashed red circle.

[illegible][illegible]

Aérodrome de Tahiti Faa'a

CREATION DE NOUVEAUX LOCAUX NRJ

Coupe AA - CC